

LIBERTY ELEMENTARY

2021 St. Mary's Avenue

Omaha, NE 68102

Program Administrator: Barb Craig

Phone: 402-898-1697

Initial Site Visit: October 18, 2007



Program Overview:

Ages served: Pre-K-6th

Serve low income children: 63% on Free & Reduced Lunch

Number of children enrolled: 566—65 Pre-K, 88—K

Number of staff: 47

Liberty Elementary School opened a temporary site in September, 2002, and the new building was completed in August, 2004. Liberty is located in the heart of downtown Omaha, providing them with many opportunities to partner with area business and agencies. Partners include the Omaha Children's Museum, YMCA and the Rose Theater. The population of the school is 58.4% Hispanic, 22.4% Caucasian, 13.7% African American, 5% Native American.

From their application:

All of the students in the four preschool classrooms come from "at-risk" circumstances. 90% are qualified for the free and reduced lunch program, 100% from urban housing. The further development of our outdoor setting would be the perfect place to conduct activities that encourage the children to explore nature on our school campus. This area would also be available to families after school hours as a natural sanctuary from the urban environment which surrounds it.

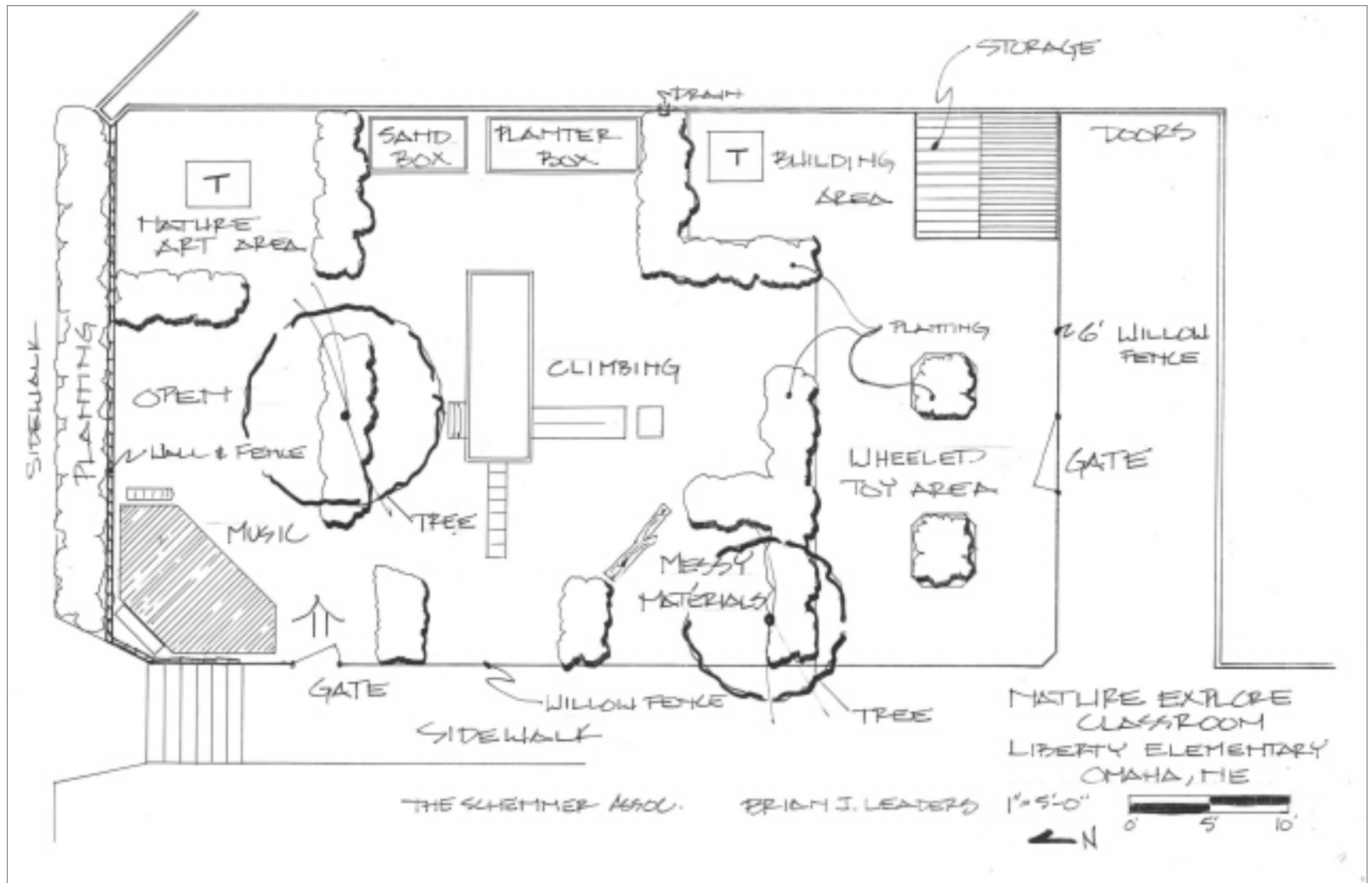

INFORMATION DEVELOPED BY NEBRASKA AEYC
www.NebraskaAEYC.org